

KACC[®]

创意无限 服务起重
Endless creativity Service lifting



浙江契卡拉起重机械有限公司
Zhejiang Qikala Lifting machinery Co.,Ltd

杭州契卡拉起重机械有限公司
Hangzhou Qikala Lifting machinery Co.,Ltd

工厂新地址: 浙江省诸暨市陶朱街道丰北路6号7栋2单元

Factory add: Building 7-2, No. 6, Fengbei Road, Taozhu Street, Zhuji City, Zhejiang Province, China

办公室地址: 杭州市萧山区临浦镇开元名庭1311、1312室

Office add: Room 1311 and 1312, Kaiyuan Mingting, Linpu Town, Xiaoshan District, Hangzhou, China

工厂电话/Factory Tel: 0571-81007299 81007599 81007199

公司电话/Office Tel: 0571-57579713 57183386

E-mail: hzxuliqiao@163.com

Http://www.kaccqzhl.com



KACC[®]

创意无限 服务起重
Endless creativity Service lifting

环链电动葫芦 Electric chain hoist

KACC[®]

Make it easier to lift

让起吊更轻松

杭州契卡拉起重机械有限公司坐落于风景优美的浙江省杭州市萧山区戴村镇工业园区，位于钱塘江畔、西子湖侧，义桥绕城出口附近，北临上海，南靠义乌国际商贸城，东靠优良国际港湾北仑港，地理位置优越，交通十分便捷。

杭州契卡拉起重机械有限公司是一家集设计、生产、销售为一体的综合性企业。公司主要生产电动葫芦、手拉葫芦、手扳葫芦、单轨行车、夹持器及其他轻小型起重类产品。产品已顺利申请并通过了生产许可证、出口许可证、欧盟“CE”等认证，并通过了ISO9001-2000质量体系认证。

公司产品已获得多项国家专利。由本公司生产的产品具有设计新颖、外形美观、体积小、重量轻、安全可靠高等特点，“KACC”品牌产品已批量进入国内外市场，并远销欧美等国家和地区，获得了客户的一致赞誉。

杭州契卡拉起重机械有限公司的宗旨是以诚为本、以信取人、以优取胜，竭诚为新老客户服务。同时热忱欢迎海内外客商前来洽谈合作。

Hangzhou Qikala Lifting Machinery Co., Ltd. is a comprehensive enterprise integrating design, production and sales. The company mainly produces chain hoists, lever hoists, monorails, grippers and other light and small lifting products. The products have been successfully applied and passed the production license, export license, EU "CE" and "GS" certification, and passed the ISO9001-2000 quality system certification.

Electric hoists, lever hoists and chain hoists have won several national patents. The products produced by our company have the characteristics of novel design, beautiful appearance, small size, light weight, high safety and reliability. The "KACC" brand products have entered the domestic and foreign markets in batches and exported to Europe and the United States and other countries and regions. Praise.

The company produces various products with complete specification and reliable quality. We will continue to innovate and explore in modern society and we promise that our corporation is able to provide the most competitive price and superior after-sale services for clients. At the same time, We also hope that we can cooperate with domestic and foreign customers sincerely.



环链电动葫芦 ELECTRIC CHAIN HOIST



DCH环链电动葫芦是一种轻小型起重设备。它结构非常紧凑、外壳采用高强度铝合金材料、体积小巧、使用维修方便、整机6年免维护。既可安装在单梁起重机上，也可安装在工字钢或H型钢上，亦可（选用固定式）固定于承重结构上使用，并可与简易龙门架配套或将电动葫芦固定安装作卷扬机起吊用。

本产品的工作环境温度为-20°C ~ +40°C,它不适用于在有爆炸危险、火灾危险、充满酸性或其它有腐蚀性气体以及相对湿度大于85%的场所里工作。不允许用来载人。操作使用应严格按GB6067-1985《起重机械安全规程》执行。如在露天场所使用，应设置防护装置，免受潮湿。

The DHL electric chain hoist is a light and small lifting device. The structure is very compact, the shell is made of high-strength aluminum alloy material, small size, easy to use and maintain, and the whole machine is maintenance-free for 6 years. It can be installed on single beam cranes or on I-beam or H-beam. It can also be fixed on the load-bearing structure (optional) and can be used for lifting with the simple gantry or the electric hoist fixed installation hoist.

The working environment temperature of this product is -20°C~+40°C. It is not intended for use in locations where there is a risk of explosion, fire, acid or other corrosive gases and a humidity greater than 85%. Not allowed to carry people. Operation should be carried out in strict accordance with GB6067-1985 (Safety Regulations for Hoisting Machinery) if used in an open space, protective equipment should be provided to protect it from moisture.

安全标准 Safety standard

所有KACC电动环链葫芦都严格按照欧盟管理和协调标准、BGV D8意外防止条例和德国设备安全法规进行设计和制造，并已获得中国特种设备型式试验合格证。

All KACC electric chain hoists are in strict accordance with EU management and coordination standards, The BGV D8 Accident Prevention Regulations and German Equipment Safety Regulations are designed and manufactured, and have obtained China Special Equipment Type Test Certificate.



悬挂吊耳 Hanging ear

可移动的悬挂吊耳设计有利于葫芦的安装与移动，同时保证了葫芦固定在一个方向。如果没有悬挂吊耳，葫芦可采用其他方式进行固定，这样将减少葫芦的净空间，增加起升高度。

The movable suspension lug design facilitates the installation and movement of the hoist move, while ensuring that the hoist is fixed in one direction. If there are no hanging lugs, the hoist can be fixed in other ways. This will reduce the net space of the hoist and increase the lifting height.



电机和齿轮箱 Motor and gearbox

电机和齿轮箱的标准化设计，为葫芦提供了范围更广的起升速度。所有电机都被制成鼠笼式结构，并配有两极和八极线圈。齿轮箱则被单独压缩。这种设计使得安装与维修更为方便。齿轮箱自润滑使得齿轮箱轮子和轴承更为平滑地行走。

The standardized design of the motor and gearbox provides a wider range of hoists lifting speed. All motors are made in a squirrel cage structure and are equipped with two and eight pole coils. The gearbox is compressed separately. This design makes easy to install and repair. The gearbox self-lubricating allows the gearbox wheels and bearings to travel more smoothly.



刹车装置 Brake

断电制动，绝缘等级155级。使用寿命长、低噪音、耐腐蚀、密封性好，使得整个刹车系统能够有较长的使用寿命。

Power-off brake, insulation class 155. Long service life, low noise, corrosion resistance, and good sealing performance enable the entire brake system to have a long service life.



摩擦片耦合式起升过载保护装置

摩擦片耦合式起升过载保护装置为葫芦的过载提供了可靠保护。特别的内衬设计极大限度的降低了磨损率，使得整个装置始终保持着高安全性的水平，并可方便地从外部对过载点进行精确调节。

The frictional load-lifting overload protection plate is provided for the riding of the hoist. Reliable protection. Special lining design greatly reduces the grinding. The damage rate keeps the entire loading at a high level of safety. And easy to adjust the point from the outside.



链条系统 Chain system

链条系统由高合金链条、导链器和导链轮组成。导链器和导链轮都是标准化设计，易于更换，大大节省时间和费用。

特制的高强度带合金镀层的链条，使得链条寿命更长，更为安全可靠。

The feeding system consists of a high-alloy strip, a guide and a guide chain. Both the chain guide and the guide chain are standardized and easy to replace. Save time and money.

The special high-strength chain with alloy plating makes the life of the strip more long, safer and more reliable.



连接插头插座标准组件

Connection plug and socket standard components

电源和控制组件连接采用插头插座标准组件，使得连接更牢固，并大大简化了安装工作，省时省力，无接线差错。在日后的维护保养工作时，它同样提供了安全便利的条件。

The connection between the power supply and the control unit is based on the standard components of the plug and socket. The connection is stronger and the installation work is greatly simplified, saving time and effort. No wiring errors. In the future maintenance work, it also mentions, provided for safe and convenient conditions.



5V电子式控制系统 5V electronic control system

KACC电子式控制系统采用无磨损的半导体技术，相较于接触器的，更节省空间和重量。

KACC electronic control system uses wear-free semiconductor technology, phase more space and weight than mechanical.



手电门 Flashlight door

KACC手电门采用人体工学设计，标准KACC电动环链葫芦手电门配有两档按钮和一个急停按钮。手电门连接采用安装方便的插头插座标准组件，并有自锁组件。

KACC flashlight door with ergonomic design, standard KACC electric. The chain hoist flashlight door is equipped with two buttons and an emergency stop button. The flashlight door connection adopts the standard components of the plug and socket that are easy to install, and has Self-locking component.

环链电动葫芦 ELECTRIC CHAIN HOIST



旋转式吊钩 Rotary hook

吊钩被设计为旋转式的，以便于操作人员轻松地起吊货物，并易于掌控吊钩方向。

The sling is designed to be rotatable so that the facilitator can easily lift the cargo and easily control the direction of the hook.



电缆 Electric cable

采用特殊结构设计，使8芯均受力更耐折柔软。缆芯外加有双道钢丝绳抗拉承载。由于采用性能优异的PVC护套比一般橡胶材质更具有抗拉性和抗撕裂强度，又保持柔软性。最小弯曲半径为: 10xD。304不锈钢快扣保证连接强度。

The special structure design makes the 8 cores evenly stressed and more flexible. The cable core is additionally provided with a two-way steel wire rope tensile load bearing. Thanks to the excellent performance of the PVC sheath, it has more tensile and tear strength than ordinary rubber materials, while maintaining softness. The minimum bending radius is: 10xD. 304 stainless steel quick buckle ensures connection strength.



变频器 Frequency converter

控制性能大幅提升，启动与停止更加平稳，同时能够适应不同的电网状况，安全性能提升，节能效果显著。

The control performance is greatly improved, the start and stop are more stable, and it can adapt to different grid conditions, the safety performance is improved, and the energy saving effect is significant.

KACC[®]

快慢双速 Fast and slow speed

每台DCH电动环链葫芦都配置有快慢双速的起升速度，DCH0125、DCH025、DCH050、DCH100的速度比均为1:4，其中DCH0125速度最快可达20M/min。

Each DCH electric chain hoist is equipped with a speed of two speeds. The speed ratio of DCH0125, DCH025, DCH050, DCH100 is 1:4 and the speed of DCH0125 is up to 20M/min.

DCH025环链电动葫芦

DCH025 ELECTRIC CHAIN HOIST



配置及特点

- 葫芦壳体: 全铝合金压铸, CNC一体加工
- 电机: 一体式三相双速异步电机
- 减速机: 磨齿加工硬齿面斜齿轮, 减速机油浴
- 链轮: 合金钢链轮
- 链条: 进口链条
- 控制板: 电路板控制, DC5V控制电压, 选配DC24V控制带相序保护
- 限位开关: CHERRY德国樱桃防水行程开关
- 手电门: 符合人体工学的最新设计手柄
- 接插件: 电源配威浦航空插头

- Electric machine: Integrated three-phase two-speed asynchronous motor
- Hoist shell: All aluminum alloy die casting, CNC-body processing
- Gearbox: Grinding machined hard toothed helical gear, gearbox oil bath
- Control board: Board control, DC5V control voltage, optional DC24V control with phase sequence protection
- Handheld: Italy imported GG handle
- Chain: Imported chain
- Chain wheel: Alloy steel sprocket
- Limit switch: The latest ergonomic design handle
- Plug-in: Power supply with Weipu aviation plug

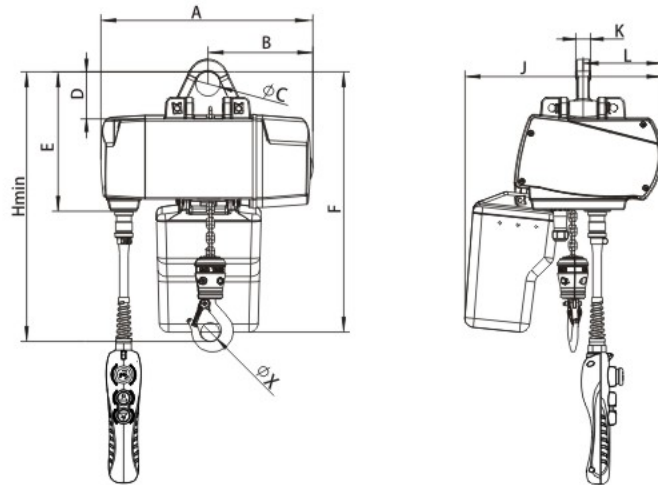

外形尺寸 Dimensions

单位/Unit: mm

型号 Model	Lifting weight 起重量(T)	A	B	C	D	E	F	Hmin	J	L	K	X
DCH025-0.125T	0.125	345	170	40	77	208	425	357	306	116	24	24
DCH025-0.25T	0.25	345	170	40	77	208	425	357	306	116	24	24
DCH025-0.5T	0.5	345	170	40	77	208	425	388	306	116	24	27
DCH025-1T	1	345	170	40	77	208	425	395	306	116	24	29

主要参数 Parameter

型号 Model	起重量 Lifting weight (T)	起升高度 Lifting height (M)	工作级别 Working level (ISO)	速度 Speed (M/MIN)	起重短链 Lifting short chain	链数 Number of chains	电机功率 Motor power (KW)	电机转速 Motor speed (RPM)	电机电流 Motor current (A)	电压 Voltage (V)	频率 Frequency (HZ)	负载持续率 Load continuation rate (FC%)	标配3米时净重 Net weight at 3 meters (KG)	包装尺寸 Package size (CM)
DCH025-0.125T	0.125	2~18	M5	5/20	4X12	1	0.17/0.7	680/2860	0.8/1.5	3P 380	50	13.4/26.6	22	52x46x40
DCH025-0.25T	0.25	2~18	M5	2/8	4X12	1	0.17/0.7	680/2860	0.8/1.5	3P 380	50	13.4/26.6	22	52x46x40
DCH025-0.5T	0.5	2~15	M5	1.5/6	5X15	1	0.17/0.7	680/2860	0.8/1.5	3P 380	50	13.4/26.6	22.6	52x46x40
DCH025-1T	1	2~10	M4	0.75/3	5X15	2	0.17/0.7	680/2860	0.8/1.5	3P 380	50	10/20	26.5	52x46x40

DCHF025变频环链电动葫芦

DCHF025 FREQUENCY CONVERSION ELECTRIC CHAIN HOIST



配置及特点

- 葫芦壳体: 全铝合金压铸, CNC一体加工
- 电机: 一体式三相双速异步电机
- 减速机: 磨齿加工硬齿面斜齿轮, 减速机油浴
- 链轮: 合金钢链轮
- 链条: 进口链条
- 控制板: 变频器控制, 五重保护: 欠压、过热、过载、过压、过流
- 限位开关: CHERRY德国樱桃防水行程开关
- 手电门: 符合人体工学的最新设计手柄
- 接插件: 电源配威浦航空插头

- Electric machine: Constant torque inverter motor
- Hoist shell: All aluminum alloy die casting, CNC-body processing
- Gearbox: Grinding machined hard toothed helical gear, gearbox oil bath
- Control board: Inverter control, five protections: undervoltage, overheating, overload, overvoltage, overcurrent
- Handheld: Italy imported GG handle
- Chain: Imported chain
- Chain wheel: Alloy steel sprocket
- Limit switch: The latest ergonomic design handle
- Plug-in: Power supply with Weipu aviation plug

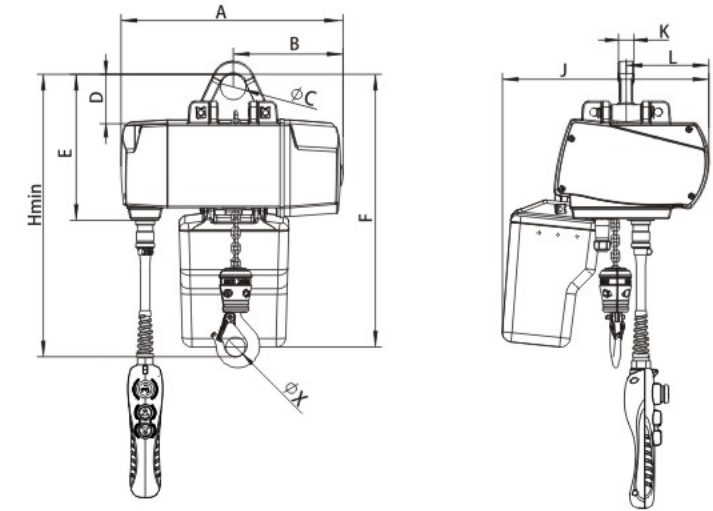

外形尺寸 Dimensions

单位/Unit: mm

型号 Model	Lifting weight 起重量(T)	A	B	C	D	E	F	Hmin	J	L	K	X
DCHF025-0.125T	0.125	345	170	40	77	208	425	357	306	116	24	24
DCHF025-0.25T	0.25	345	170	40	77	208	425	357	306	116	24	24
DCHF025-0.5T	0.5	345	170	40	77	208	425	388	306	116	24	27
DCHF025-1T	1	345	170	40	77	208	425	395	306	116	24	29

主要参数 Parameter

型号 Model	起重量 Lifting weight (T)	起升高度 Lifting height (M)	工作级别 Working level (ISO)	速度 Speed (M/MIN)	起重短链 Lifting short chain	链数 Number of chains	电机功率 Motor power (KW)	电机转速 Motor speed (RPM)	电机电流 Motor current (A)	电压 Voltage (V)	频率 Frequency (HZ)	负载持续率 Load continuation rate (FC%)	标配3米时净重 Net weight at 3 meters (KG)	包装尺寸 Package size (CM)
DCHF025-0.125T	0.125	2~18	M5	5/20	4X12	1	0.7	2860	2.8	1P 220	50/60	40	22	52x46x40
DCHF025-0.25T	0.25	2~18	M5	2/8	4X12	1	0.7	2860	2.8	1P 220	50/60	40	22	52x46x40
DCHF025-0.5T	0.5	2~15	M5	1.5/6	5X15	1	0.7	2860	2.8	1P 220	50/60	40	22.6	52x46x40
DCHF025-1T	1	2~10	M4	0.75/3	5X15	2	0.7	2860	2.8	1P 220	50/60	40	26.5	52x46x40

DCHF100变频环链电动葫芦

DCHF100 FREQUENCY CONVERSION ELECTRIC CHAIN HOIST

配置及特点

- 葫芦壳体: 全铝合金压铸, CNC一体加工
- 电机: 一体式三相双速异步电机
- 减速机: 磨齿加工硬齿面斜齿轮, 减速机油浴
- 链轮: 合金钢链轮
- 链条: 进口链条
- 控制板: 变频器控制, 五重保护: 欠压、过热、过载、过压、过流
- 限位开关: CHERRY德国樱桃防水行程开关
- 手电门: 符合人体工学的最新设计手柄
- 接插件: 电源配威浦航空插头

- Electric machine: Constant torque inverter motor
- Hoist shell: All aluminum alloy die casting, CNC-body processing
- Gearbox: Grinding machined hard toothed helical gear, gearbox oil bat
- Control board: Inverter control, five protections: undervoltage, overheating, overload, overvoltage, overcurrent
- Handheld: Italy imported GG handle
- Chain: Imported chain
- Chain wheel: Alloy steel sprockets
- Limit switch: The latest ergonomic design handle
- Plug-in: Power supply with Weipu aviation plug

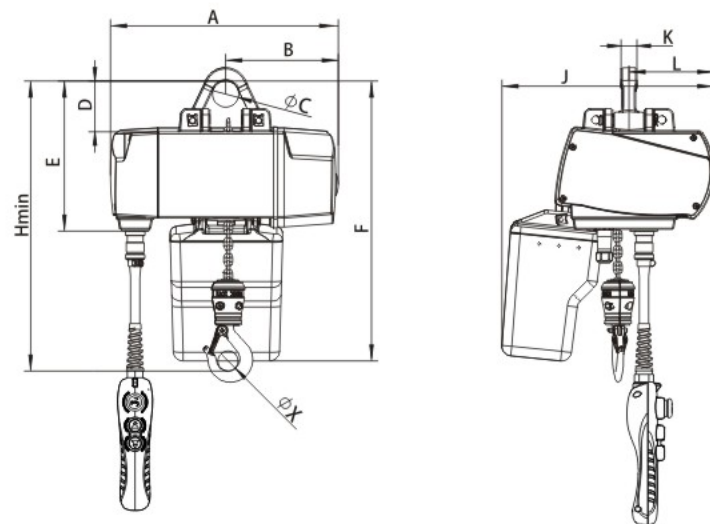

外形尺寸 Dimensions

单位/Unit: mm

型号 Model	Lifting weight 起重量(T)	A	B	C	D	E	F	Hmin	J	L	K	X
DCHF100-0.5T	0.5	458	204	40	77	263	528	519	427	177	24	45
DCHF100-1T	1	458	204	40	77	263	528	519	427	177	24	45
DCHF100-2T	2	458	204	40	77	263	528	544	427	177	24	45

主要参数 Parameter

型号 Model	起重量 Lifting weight (T)	起升高度 Lifting height (M)	工作级别 Working level (ISO)	速度 Speed (M/MIN)	起重短链 Lifting short chain	链数 Number of chains	电机功率 Motor power (KW)	电机转速 Motor speed (RPM)	电机电流 Motor current (A)	电压 Voltage (V)	频率 Frequency (HZ)	负载持续率 Load continuation rate (FC%)	标配3米时净重 Net weight at 3 meters (KG)	包装尺寸 Package size (CM)
DCHF100-0.5T	0.5	2~18	M5	4/16	7x21	1	1.9	2860	3.8	3P 380	50/60	40	47.5	65x53x39
DCHF100-1T	1	2~18	M5	2/8	7x21	1	1.9	2860	3.8	3P 380	50/60	40	47.5	65x53x39
DCHF100-2T	2	2~15	M5	1/4	7x21	2	1.9	2860	3.8	3P 380	50/60	40	52.6	65x53x39

DCHF200变频环链电动葫芦

DCHF200 FREQUENCY CONVERSION ELECTRIC CHAIN HOIST

配置及特点

- 葫芦壳体: 全铝合金压铸, CNC一体加工
- 电机: 一体式三相双速异步电机
- 减速机: 磨齿加工硬齿面斜齿轮, 减速机油浴
- 链轮: 合金钢链轮
- 链条: 进口链条
- 控制板: 变频器控制, 五重保护: 欠压、过热、过载、过压、过流
- 限位开关: CHERRY德国樱桃防水行程开关
- 手电门: 符合人体工学的最新设计手柄
- 接插件: 电源配威浦航空插头

- Electric machine: Constant torque inverter motor
- Hoist shell: All aluminum alloy die casting, CNC-body processing
- Gearbox: Grinding machined hard toothed helical gear, gearbox oil bat
- Control board: Inverter control, five protections: undervoltage, overheating, overload, overvoltage, overcurrent
- Handheld: Italy imported GG handle
- Chain: Imported chain
- Chain wheel: Alloy steel sprockets
- Limit switch: The latest ergonomic design handle
- Plug-in: Power supply with Weipu aviation plug

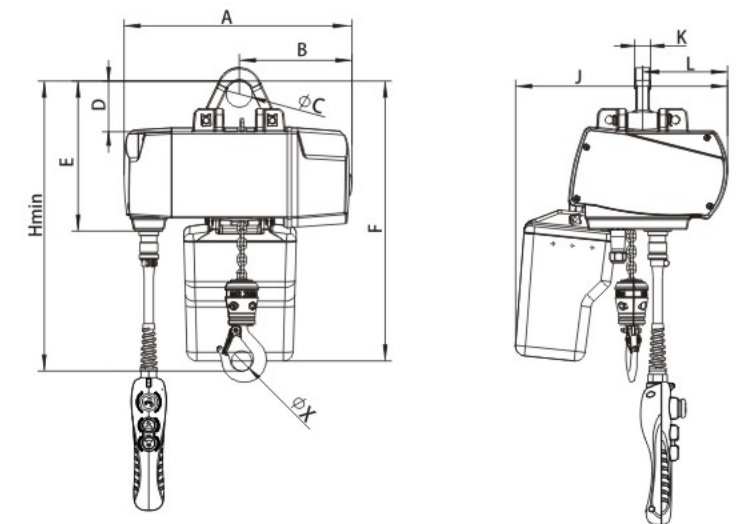

外形尺寸 Dimensions

单位/Unit: mm

型号 Model	Lifting weight 起重量(T)	A	B	C	D	E	F	Hmin	J	L	K	X
DCHF200-2T	2	518	230	65	106	366	613	622	453	195	28	50
DCHF200-3.2T	3.2	518	230	65	106	366	613	702	453	195	28	60
DCHF200-4T	4	518	230	65	106	366	613	702	453	195	28	60

主要参数 Parameter

型号 Model	起重量 Lifting weight (T)	起升高度 Lifting height (M)	工作级别 Working level (ISO)	速度 Speed (M/MIN)	起重短链 Lifting short chain	链数 Number of chains	电机功率 Motor power (KW)	电机转速 Motor speed (RPM)	电机电流 Motor current (A)	电压 Voltage (V)	频率 Frequency (HZ)	负载持续率 Load continuation rate (FC%)	标配3米时重量 Weight at 3 meters (KG)	包装尺寸 Package size (CM)
DCHF200-2T	2	2~18	M5	2/8	10x28	1	3.5	2860	7	3P 380	50	40	85/97	62x58x44
DCHF200-3.2T	3.2	2~18	M5	1.3/5	10x28	2	3.5	2860	7	3P 380	50	30	97/109	62x58x44
DCHF200-4T	4	2~15	M5	1/4	10x28	2	3.5	2860	7	3P 380	50	30	97/109	62x58x44

遥控手持控制变频葫芦

REMOTE CONTROL HANDHELD CONTROL FREQUENCY CONVERSION HOIST



配置及特点

- 葫芦壳体:** 全铝合金压铸壳体 (包括齿轮箱及电机后壳); CNC一体加工; 结构紧凑密封性好; 表面汽车级烤漆。
- 齿轮箱:** 免维护齿轮箱。齿轮为高强度精密斜齿轮, 传动效率高且平稳, 噪音更小使用寿命更高。
- 摩擦离合器:** 能有效起到过载保护作用, 从而避免因超载使用带来的安全事故。
- 制动器:** 失电式制动器, 断电制动。双摩擦面提供大摩擦力。制动迅速磨损小, 更安全。
- 葫芦电机:** 高效变频电机, 配热保护装置。
- 链条:** 德国进口链条RUD。使用寿命更长运行更稳定。
- 导链部分:** 定制配方高强度耐磨工程塑料作导链器。降低链条磨损与噪音。采用高强度尼龙挡链板防止错乱打结链条进入导链器。
- 电器部分:** 变频器控制, 五重保护: 欠压、过热、过载、过压、过流。
- 手持控制:** 人体工学手持手柄, 保护更全面。人体工学设计手柄, 握感舒适操作灵敏无延迟。非接触式按钮, 无机械寿命损耗, 寿命更长。
- 吊钩:** 采用合金钢锻造加工而成。360° 随意旋转。

- Hoist shell:** All aluminum alloy die-casting shell (including gear box and motor back shell); CNC-body processing; compact structure and good airtightness; surface automotive grade paint.
- Gearbox:** Maintenance free gearbox. The gear is a high-strength helical gear, which has high transmission efficiency and smoothness, and lower noise and higher service life.
- Friction clutch:** It can effectively protect against overload and avoid safety accidents caused by overload.
- Actuator:** Loss of electric brake, power off brake. The double friction surface provides high friction. The brakes are smooth and wear less and safer.
- Electric machine:** High energy efficiency frequency conversion motor, equipped with thermal protection device.
- Chain:** Germany imported chain RUD. Longer service life and more stable operation.
- Guide chain part:** Customized formula high-strength wear-resistant engineering plastics as a chain guide. Reduce chain wear and noise. Use high-strength nylon chain links to prevent inadvertent knotting of chains into the chain guide.
- Electrical part:** Integrated circuit board control. Multi-layer control protection.
- Handheld control:** The ergonomically designed handle makes the grip comfortable and sensitive without delay. Non-contact button, no mechanical life loss, longer life. The grip bump design ensures friction with oil in hand.
- Hook:** It is forged with alloy steel. 360° free rotation.

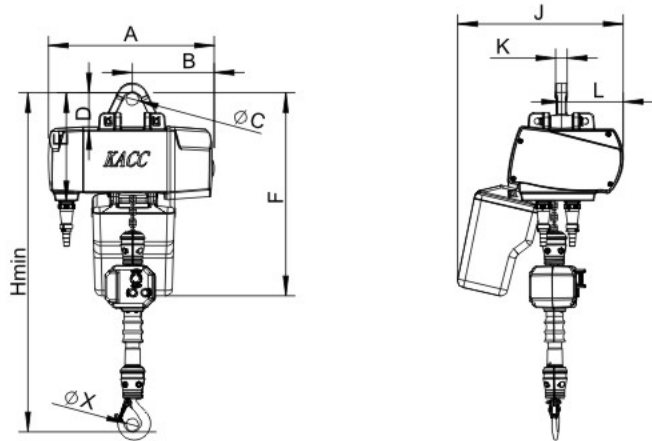

外形尺寸 Dimensions

单位/Unit: mm

型号 Model	Lifting weight 起重量(T)	A	B	C	D	E	F	Hmin	J	L	K	X
DCHSF025-0.125T	0.125	345	170	40	77	231	425	700	321	128	24	24
DCHSF025-0.25T	0.25	345	170	40	77	231	425	700	321	128	24	24
DCHSF025-0.5T	0.5	345	170	40	77	231	425	700	321	128	24	24
DCHSF100-1T	1	458	204	40	127	263	528	845	427	177	24	35

主要参数 Parameter

型号 Model	起重量 Lifting weight (T)	起升高度 Lifting height (M)	工作级别 Working level (ISO)	速度 Speed (M/MIN)	起重短链 Lifting short chain	链数 Number of chains	电机功率 Motor power (KW)	电机转速 Motor speed (RPM)	电机电流 Motor current (A)	电压 Voltage (V)	频率 Frequency (HZ)	负载持续率 Load continuation rate (FC%)	标配3米时净重 Net weight at 3 meters (KG)	包装尺寸 Package size (CM)
DCHS-0.125T	0.125	2~18	M5	5/20	4X12	1	0.17/0.7	680/2860	0.8/1.5	3P 380	50	13.4/26.6	23	52x46x40
DCHS-0.25T	0.25	2~18	M5	2/8	4X12	1	0.17/0.7	680/2860	0.8/1.5	3P 380	50	13.4/26.6	23	52x46x40
DCHS-0.5T	0.5	2~15	M5	1.5/6	5X15	1	0.17/0.7	680/2860	0.8/1.5	3P 380	50	13.4/26.6	23.6	52x46x40

手持控制变频葫芦

HAND-HELD CONTROL FREQUENCY HOIST



配置及特点

- 葫芦壳体:** 全铝合金压铸壳体 (包括齿轮箱及电机后壳); CNC一体加工, 结构紧凑密封性好, 表面汽车级烤漆。
- 齿轮箱:** 免维护齿轮箱, 齿轮为高强度斜齿轮, 传动效率高且平稳, 噪音更小使用寿命更高。
- 摩擦离合器:** 能有效起到过载保护作用, 从而避免因超载使用带来的安全事故。
- 制动器:** 失电式制动器, 断电制动。双摩擦面提供大摩擦力。制动平稳磨损小, 更安全。
- 葫芦电机:** 采用变频电机。恒扭矩输出保证足够的提升力矩, 转换效率高、负载率高。可为顾客定制提升速度, 配有过热保护装置。
- 链条:** 进口链条, 使用寿命更长运行更稳定。
- 导链部分:** 定制配方高强度耐磨工程塑料作导链器。降低链条磨损与噪音, 采用高强度尼龙挡链板防止错乱打结链条进入导链器。
- 电器部分:** 市电220v供电即插即用, 变频控制, 五重保护: 欠压、过热、过载、过压、过流。节能环保, 启停平稳, 加减速定制。
- 手持控制:** 全铝合金手持手柄, 保护更全面, 人体工学设计手柄, 握感舒适操作灵敏无延迟。非接触式按钮, 无机械寿命损耗, 寿命更长, 握柄凸点设计保证带油手持条件下的摩擦力。采用合金钢锻造加工而成, 360° 随意旋转, 吊钩标配安全保险片保证安全。
- Hoist shell:** All aluminum alloy die-casting shell (including gear box and motor back shell); CNC-body processing; compact structure and good airtightness; surface automotive grade paint.
- Gearbox:** Maintenance free gearbox. The gear is a high-strength helical gear, which has high transmission efficiency and smoothness, and lower noise and higher service life.
- Friction clutch:** It can effectively protect against overload and avoid safety accidents caused by overload.
- Actuator:** Loss of electric brake, power off brake. The double friction surface provides high friction. The brakes are smooth and wear less and safer.
- Electric machine:** Energy-efficient two-speed motor with thermal protection to protect the motor.
- Chain:** Imported chain. Longer service life and more stable.
- Guide chain part:** Customized formula high-strength wear-resistant engineering plastics as a chain guide. Reduce chain wear and noise. Use high-strength nylon chain links to prevent inadvertent knotting of chains into the chain guide.
- Electrical part:** Integrated circuit board control. Multi-layer control protection.
- Handheld control:** All-aluminum hand-held handle for more comprehensive protection. The ergonomically designed handle makes the grip comfortable and sensitive without delay. Non-contact button, no mechanical life loss, longer life. The grip bump design ensures friction with oil in hand. It is made of alloy steel forging. 360° free to rotate. Hooks come standard with safety fuses for safety.
- Hook:** It is forged with alloy steel. 360° free to rotate. Hooks come standard with safety fuses for safety.

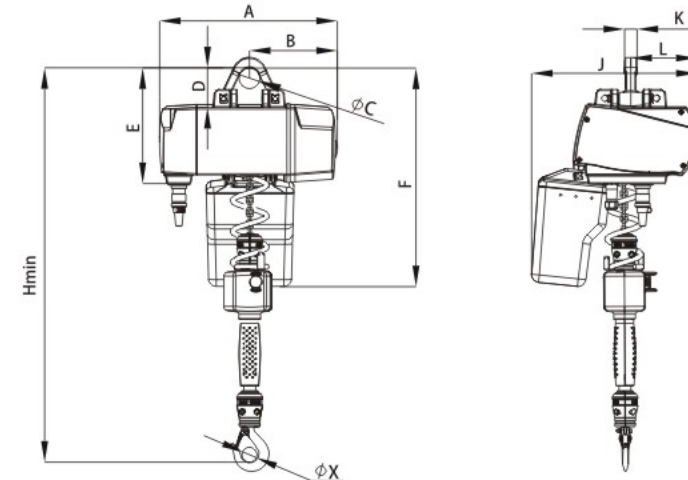

外形尺寸 Dimensions

单位/Unit: mm

型号 Model	Lifting weight 起重量(T)	A	B	C	D	E	Hmin	F	J	L	K	X
DCHSF025-0.125T	0.125	345	170	40	77	231	950	425	321	128	24	24
DCHSF025-0.25T	0.25	345	170	40	77	231	950	425	321	128	24	24
DCHSF025-0.5T	0.5	345	170	40	77	231	950	425	321	128	24	24
DCHSF100-0.5T	0.5	458	204	40	77	263	1100	528	427	177	24	45
DCHSF100-1T	1	458	204	40	77	263	1100	528	427	177	24	45

主要参数 Parameter

2m以上提升高度需外接遥控器

型号 Model	起重量 Lifting weight (T)	起升高度 Lifting height (M)	工作级别 Working level (ISO)	速度 Speed (M/MIN)	起重短链 Lifting short chain	链数 Number of chains	电机功率 Motor power (KW)	电机转速 Motor speed (RPM)	电机电流 Motor current (A)	电压 Voltage (V)	频率 Frequency (HZ)	负载持续率 Load continuation rate (FC%)	标配3米时净重 Net weight at 3 meters (KG)	包装尺寸 Package size (CM)
DCHSF025-0.125T	0.125	2~6	M5	5/20	4X12	1	0.7	2860	2.5	1P 220	50/60	40	23	52x46x40
DCHSF025-0.25T	0.25	2~6	M5	2/8	4X12	1	0.7	2860	2.5	1P 220	50/60	40	23	52x46x40
DCHSF025-0.5T	0.5	2~6	M5	1.5/6	5X15	1	0.7	2860	2.5	1P 220	50/60	40	23.6	52x46x40
DCHSF100-0.5T	0.5	2~6	M5	4/16	7X21	1	1.9	2860	3.8	3P 380	50/60	40	49	65x53x39
DCHSF100-1T	1	2~6	M5	2/8	7X21	1	1.9	2860	3.8	3P 380	50/60	40	49	65x53x39

DCH-PM电动环链葫芦手推小车

DCH-PM ELECTRIC CHAIN HOIST HAND PUSH TROLLEY



产品特点

手推小车电动葫芦，小车之间的距离可以调整，适用于多种工字钢。起重量从0.5吨到2吨，在重力作用下可自行调整高度，使四个车轮实力均匀。产品传动效率高，手推力小，并可在较小的回转半径的弯道上形式。

手推小车电动葫芦是一种方便的起重工具，可以达到横行移动即左右行走的目的。

Push the trolley electric hoist, the distance between the trolleys can be adjusted, suitable for a variety of I-beams. The lifting weight ranges from 0.5 tons to 2 tons, and the height can be adjusted by gravity to make the four wheels evenly. The product has high transmission efficiency, small hand thrust and can be used in corners with small radius of gyration.

The push-pull electric hoist is a convenient lifting tool that can achieve the purpose of moving horizontally or left and right

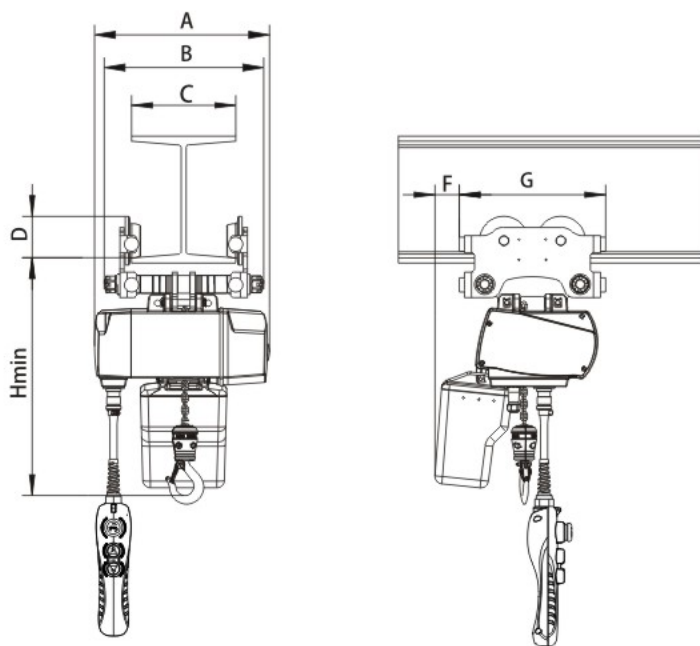

外形尺寸 Dimensions

型号 Model	Lifting weight 起重量(T)	A	B	C	D	F	Hmin	G
DCH025-PM-0.5T	0.5	345	314	85-205	81	48	468	288
DCH100-PM-0.5T	0.5	457	325	98-202	95	81	565	338
DCH025-PM-1T	1	345	314	85-205	81	8	468	288
DCH100-PM-1T	1	457	325	98-202	95	81	565	338
DCH100-PM-2T	2	457	355	100-200	117	55	601	390

主要参数 Parameter

型号 Model	起重量 Lifting weight (T)	起升高度 Lifting height (M)	工作级别 Working level (ISO)	速度 Speed (M/MIN)	起重短链 Lifting short chain	链数 Number of chains	电机功率 Motor power (KW)	负载持续率 Load continuation rate (FC%)	最小转弯半径 Minimum turning radius (m)	适用轨道宽度 Applicable track width (mm)	标配3米时净重 Net weight at 3 meters (KG)	包装尺寸 Package size (CM)
DCH025-PM-0.5T	0.5	2~18	M5	1.5/6	5x15	1	0.17/0.7	13.4/26.6	1.2	85-205	46.3	52x46x40
DCH100-PM-0.5T	0.5	2~18	M5	4/16	7x21	1	0.45/1.9	13.4/26.6	1.5	98-202	69.7	65x53x39
DCH025-PM-1T	1	2~18	M5	0.75/3	5x15	2	0.17/0.7	13.4/26.6	1.2	85-205	51.2	52x46x40
DCH100-PM-1T	1	2~18	M5	2/8	7x21	1	0.45/1.9	13.4/26.6	1.5	98-202	69.7	65x53x39
DCH100-PM-2T	2	2~15	M5	1/4	7x21	2	0.45/1.9	13.4/26.6	1.8	100-200	78.6	65x53x39

DCH-GM电动环链葫芦电动小车

DCH-GM ELECTRIC CHAIN HOIST ELECTRIC TROLLEY



产品特点

1. 启动与制动平滑
2. 搬运载荷时防摇
3. 安装、调试快捷
4. 专为为DCH环链葫芦而设计
5. 通过PL031HP03.D4手电门来控制
6. 即插即用特性，可快速提高可用性：备有与DCH环链葫芦连接的插入连接件
7. 电动小车选配使用控制板控制，并集成进DCH环链葫芦壳内。
8. 双小车螺杆设计安全稳定

1. Start and brake smoothing
2. Anti-shake when carrying loads
3. Installation, debugging is fast
4. Designed for DCH chain hoists
5. Controlled by PL031HP03.D4 flashlight door
6. Plug and play features for fast availability: plug connectors for connection to DCH chain hoists
7. The electric trolley is controlled by the control panel and integrated into the DCH chain hoist shell.
8. Double trolley screw design is safe and stable

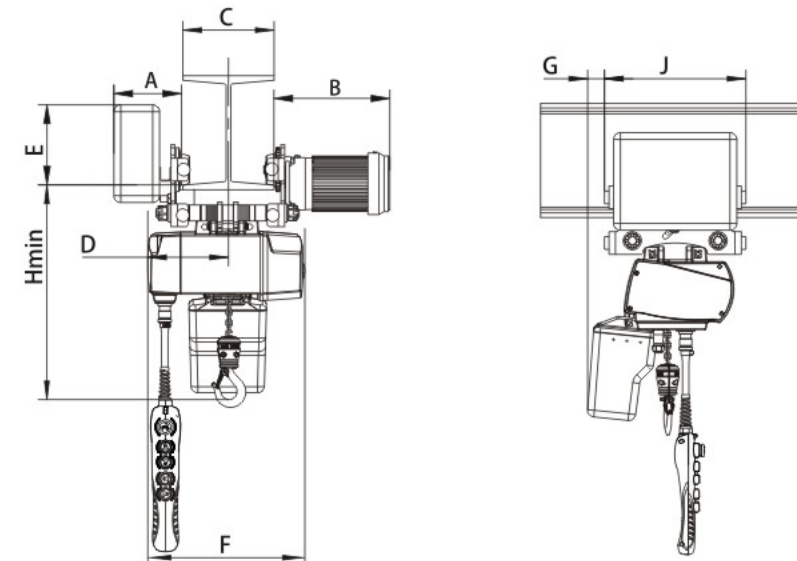

外形尺寸 Dimensions

型号 Model	Lifting weight 起重量(T)	A	B	C	D	E	F	Hmin	G	J
DCH025-GM-0.5T	0.5	150	254	90-200	177	176	344	471	37	310
DCH100-GM-0.5T	1	150	257	90-200	256	176	457	560	73	354
DCH025-GM-1T	0.5	150	254	90-200	177	176	344	471	37	310
DCH100-GM-1T	1	150	257	90-200	256	176	457	560	73	354
DCH100-GM-2T	2	157	305	100-200	256	180	457	596	48	404

主要参数 Parameter

型号 Model	起重量 Lifting weight (T)	起升高度 Lifting height (M)	工作级别 Working level (ISO)	速度 Speed (M/MIN)	起重短链 Lifting short chain	链数 Number of chains	电机功率 Motor power (KW)	运行速度 Running speed (M/MIN)	运行功率 Running power (KW)	负载持续率 Load continuation rate (FC%)	最小转弯半径 Minimum turning radius (m)	适用轨道宽度 Applicable track width (mm)	标配3米时净重 Net weight at 3 meters (KG)	包装尺寸 Package size (CM)
DCH025-GM-0.5T	0.5	2~18	M5	1.5/6	5x15	1	0.17/0.7	20	0.2	30	1.2	85-205	48.6	64x39x49
DCH100-GM-0.5T	0.5	2~18	M5	4/16	7x21	1	0.45/1.9	20	0.2	30	1.5	98-202	73.5	64x39x49
DCH025-GM-1T	1	2~18	M5	0.75/3	5x15	2	0.17/0.7	20	0.2	30	1.2	85-205	53.5	64x39x49
DCH100-GM-1T	1	2~18	M5	2/8	7x21	1	0.45/1.9	20	0.2	30	1.5	98-202	73.5	72x44x56
DCH100-GM-2T	2	2~15	M5	1/4	7x21	2	0.45/1.9	20	0.4	30	1.8	100-200	88.9	76x48x59

DCH-FGM变频环链葫芦电动小车

DCH-FGM FREQUENCY CONVERSION CHAIN HOIST ELECTRIC TROLLEY



产品特点

1. 启动与制动平滑
2. 搬运载荷时防摇
3. 安装、调试快捷
4. 专为为DCH环链葫芦而设计
5. 通过PL031HP03.D4手电门来控制
6. 即插即用特性，可快速提高可用性：备有与DCH环链葫芦连接的插入连接件
7. 电动小车变频控制，节能环保。
8. 双小车螺杆设计安全稳定

1. Start and brake smoothing
2. Anti-shake when carrying loads
3. Installation, debugging is fast
4. Designed for DCH chain hoists
5. Controlled by PL031HP03.D4 flashlight door
6. Plug and play features for fast availability: plug connectors for connection to DCH chain hoists
7. Electric car inverter control, energy saving and environmental protection.
8. Double trolley screw design is safe and stabl

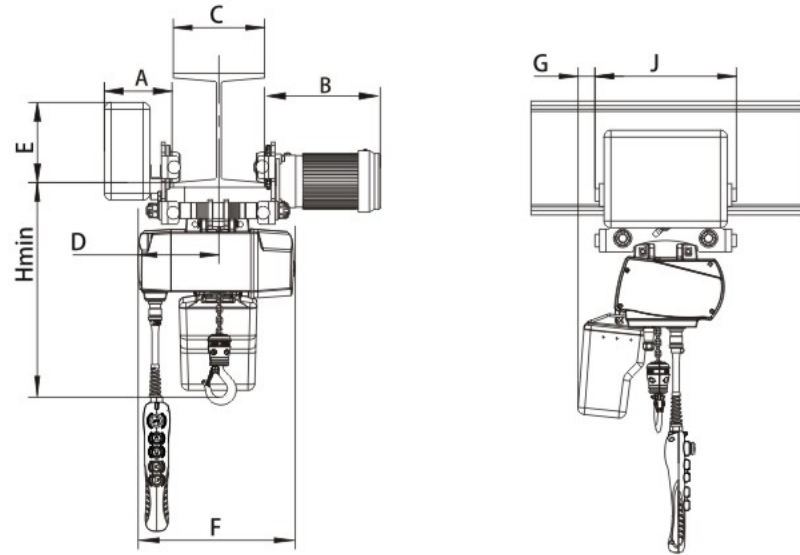

外形尺寸 Dimensions

型号 Model	Lifting weight 起重量(T)	A	B	C	D	E	F	Hmin	G	J
DCH025-FGM-0.5T	0.5	150	254	90-200	177	176	344	471	37	310
DCH100-FGM-0.5T	1	150	257	90-200	256	176	457	560	73	354
DCH025-FGM-1T	0.5	150	254	90-200	177	176	344	471	37	310
DCH100-FGM-1T	1	150	257	90-200	256	176	457	560	73	354
DCH100-FGM-2T	2	157	305	100-200	256	180	457	596	48	404

主要参数 Parameter

型号 Model	起重量 Lifting weight (T)	起升高度 Lifting height (M)	工作级别 Working level (ISO)	速度 Speed (M/MIN)	起重短链 Lifting short chain	链数 Number of chains	电机功率 Motor power (KW)	运行速度 Running speed (M/MIN)	运行功率 Running power (KW)	负载持续率 Load continuation rate (FC%)	最小转弯半径 Minimum turning radius (m)	适用轨道宽度 Applicable track width (mm)	标配3米时净重 Net weight at 3 meters (KG)	包装尺寸 Package size (CM)
DCH025-FGM-0.5T	0.5	2~18	M5	1.5/6	5x15	1	0.7	5/20	0.2	30	1.2	85-205	48.6	64x39x49
DCH100-FGM-0.5T	0.5	2~18	M5	4/16	7x21	1	1.9	5/20	0.2	30	1.5	98-202	73.5	64x39x49
DCH025-FGM-1T	1	2~18	M5	0.75/3	5x15	2	0.7	5/20	0.2	30	1.2	85-205	53.5	64x39x49
DCH100-FGM-1T	1	2~18	M5	2/8	7x21	1	1.9	5/20	0.2	30	1.5	98-202	73.5	72x44x56
DCH100-FGM-2T	2	2~15	M5	1/4	7x21	2	1.9	5/20	0.4	30	1.8	100-200	88.9	76x48x59

DCHD倒挂环链电动葫芦

DCHD UPSIDE DOWN ELECTRIC CHAIN HOIST

产品介绍

本款电动葫芦专门为大型演出场合、吊装灯光架、扬声器组、大型布景装置而设计的。也适用于其他临时流动场合的起重，如：霓虹灯广告立牌的安装，小型建筑工地等。

主要特点是：使用时只需将带钩的链条一端挂在上梁上。而下面的葫芦带着被吊物件一起顺着链条向上爬行至预定的高度。因此使用时十分方便省力。M5工作级别满足频繁使用场合

配置及特点

葫芦壳体：全铝合金压铸，CNC一体加工

电机：一体式三相双速异步电机

减速箱：磨齿加工硬齿面斜齿轮，减速箱油浴

链轮：合金钢链轮

链条：进口链条

控制板：电路板控制，DC5V控制电压，选配DC24V控制带相序保护

限位开关：CHERRY德国樱桃防水行程开关

手电门：符合人体工学的最新设计手柄

接插件：电源配威浦航空插头

Hoist shell: All aluminum alloy die casting, CNC-body processing

Electric machine: Integrated three-phase two-speed asynchronous motor

Gearbox: Grinding machined hard toothed inclined halogen wheel, gearbox oil bath

Chain wheel: Alloy steel sprocket

Chain: Imported chain

Control board: Board control, DC5V control voltage, optional. DC24V control with phase sequence protection

Limit switch: CHERRY German Cherry Waterproof Travel Switch

Handheld: The latest ergonomic design handle

Plug-in: Power supply with Weipu aviation plug

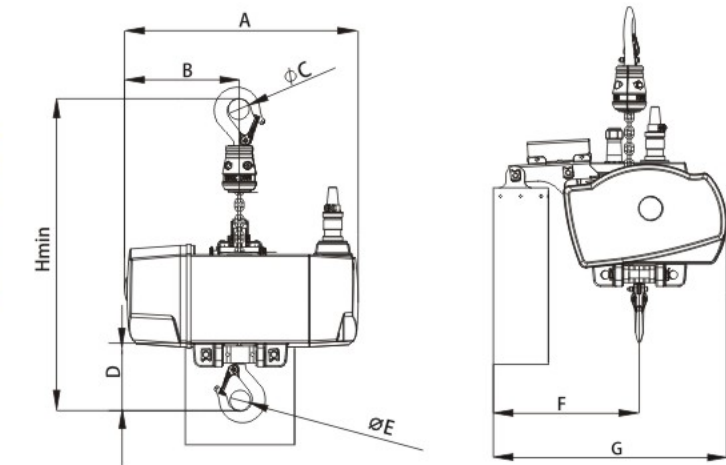

外形尺寸 Dimensions

型号 Model	Lifting weight 起重量(T)	A	B	C	D	E	F	Hmin	G
DCHD025-0.125T	0.125	345	170	30	100	30	215	435	344
DCHD025-0.25T	0.25	345	170	30	100	30	215	435	344
DCHD025-0.5T	0.5	345	170	32	130	32	215	495	344
DCHD100-1T	1	455	202	40	152	40	298	395	474

主要参数 Parameter

型号 Model	起重量 Lifting weight (T)	起升高度 Lifting height (M)	工作级别 Working level (ISO)	速度 Speed (M/MIN)	起重短链 Lifting short chain	链数 Number of chains	电机功率 Motor power (KW)	电机转速 Motor speed (RPM)	电机电流 Motor current (A)	电压 Voltage (V)	频率 Frequency (HZ)	负载持续率 Load continuation rate (FC%)	标配3米时净重 Net weight at 3 meters (KG)	包装尺寸 Package size (CM)
DCHD025-0.125T	0.125	2~18	M5	5/20	4X12	1	0.17/0.7	680/2860	0.8/1.5	3P 380	50	13.4/26.6	22	52x46x40
DCHD025-0.25T	0.25	2~18	M5	2/8	4X12	1	0.17/0.7	680/2860	0.8/1.5	3P 380	50	13.4/26.6	22	52x46x40
DCHD025-0.5T	0.5	2~15	M5	1.5/6	5X15	1	0.17/0.7	680/2860	0.8/1.5	3P 380	50	13.4/26.6	22.6	52x46x40
DCHD100-1T	1	2~10	M5	2/8	7X21	1	0.45/1.9	680/2860	2.0/3.8	3P 380	50	13.4/26.6	47.5	65x53x39

DCH-YDG超低净空变频电动葫芦小车
DCH-YDG LOW HEADROOM VARIABLE FREQUENCY
ELECTRIC HOIST WITH TROLLEY



产品特点

1. 启动与制动平滑
 2. 搬运载荷时防摇
 3. 安装、调试快捷
 4. 专为DCH环链葫芦而设计
 5. 通过手电门来控制
 6. 即插即用特性，可快速提高可用性：备有与DCH环链葫芦连接的插入连接件
 7. 电动小车选配使用控制板控制，并集成进DCH环链葫芦壳内。
 8. 双小车螺杆设计安全稳定
1. Start and brake smoothing
 2. Anti-shake when carrying loads
 3. Installation, debugging is fast
 4. Designed for DCH chain hoists
 5. Controlled by flashlight door
 6. Plug and play features for fast availability: plug connectors for connection to DCH chain hoists
 7. The electric trolley is controlled by the control panel and integrated into the DCH chain hoist shell.
 8. Double trolley screw design is safe and stable

DCH-YDG超低净空变频电动葫芦小车
DCH-YDG LOW HEADROOM VARIABLE FREQUENCY
ELECTRIC HOIST WITH TROLLEY

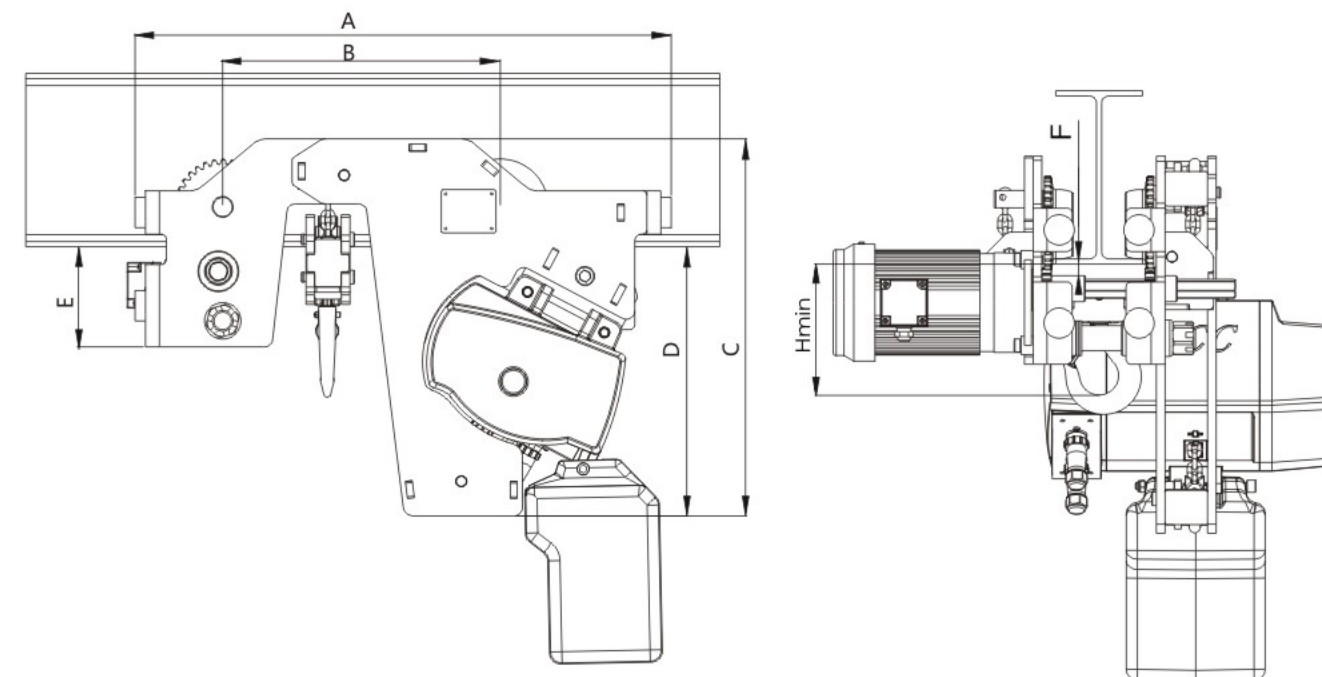

外形尺寸 Dimensions

单位/Unit: mm

型号 Model	起重量 Lifting weight (T)	A	B	C	D	E	F	Hmin	G
DCH025-YDG-1T	1	618	355	430	310.5	115.5	19	151	30
DCH100-YDG-2T	2	813	485	537	382	144	25.5	197	37
DCH100-YDG-3T	3	989	610	695	500	155	26.5	217	37
DCH100-YDG-5T	5	989	610	695	500	155	26.5	217	47

主要参数 Parameter

型号 Model	起重量 Lifting weight (T)	起升高度 Lifting height (M)	工作级别 Working level (ISO)	速度 Speed (M/MIN)	起重短链 Lifting short chain	链数 Number of chains	电机功率 Motor power (KW)	运行速度 Running speed (M/MIN)	运行功率 Running power (KW)	负载持续率 Load continuation rate (FC%)	最小转弯半径 Minimum turning radius (m)	适用轨道宽度 Applicable track width (mm)	包装尺寸 Package size (CM)
DCH025-YDG-1T	1	2~18	M5	0.75/3	5x15	2	0.17/0.7	16	0.2	40	2	85-205	90x74x69
DCH100-YDG-2T	2	2~18	M5	1/4	7x21	2	1.9	16	0.4	40	2	98-202	90x74x69
DCH100-YDG-3T	3	2~15	M5	1/4	10x28	2	3.5	16	0.4	40	2.5	100-200	
DCH100-YDG-5T	5	2~15	M4	0.8/3.2	10x28	2	3.5	16	0.4	30	2.5	100-200	

ZBD环链葫芦折臂吊 ZBD CHAIN HOIST FOLDING ARM CRANE



ZBD环链葫芦折臂吊

1. 起升重量由0.125t到0.5t。
2. 作业半径内无盲区(一般折臂吊靠近立柱有较大的作业盲区)。
3. 葫芦壳体——全铝合金压铸壳体(包括齿轮箱及电机后壳), CNC一体加工, 结构紧凑密闭性好, 表面汽车级烤漆。
4. 齿轮箱——免维护齿轮箱, 齿轮为高强度斜齿轮, 传动效率高且平稳, 噪音更小使用寿命更高。
5. 摩擦离合器——能有效起到过载保护作用, 从而避免因超载使用带来的安全事故。
6. 制动器——失电式制动器, 断电制动, 双摩擦面提供大摩擦力, 制动平稳磨损小, 更安全。
7. 葫芦电机——采用变频电机, 恒扭矩输出保证足够的提升力矩, 转换效率高、负载率高, 可为顾客定制提升速度, 配有过热保护装置。
8. 链条——高强度德国进口RUD链条, 使用寿命更长运行更稳定。
9. 导链部分——定制配方高强度耐磨工程塑料作导链器, 降低链条磨损与噪音, 采用高强度尼龙挡链板防止错乱打结链条进入导链器。
10. 电器部分——市电220V供电即插即用, 变频控制, 五重保护: 欠压、过热、过载、过压、过流。节能环保, 启停平稳, 加减速定制。
11. 手持控制——全铝合金手持手柄, 保护更全面。人体工学设计手柄, 握感舒适操作灵敏无延迟, 非接触式按钮, 无机械寿命损耗, 寿命更长, 握柄凸点设计保证带油手持条件下的摩擦力。
12. 吊钩——采用合金钢锻造加工而成, 360° 随意旋转, 吊钩标配安全保险片保证安全。
13. 折臂吊起升高度和工作半径可根据客户场地和使用要求进行一对一定制。
14. 图为移动式折臂吊, 当工作半径超过3m或工作环境允许, 优先选用固定式折臂吊, 安全稳固。

ZBD chain hoist folding arm crane

1. Lifting weight from 0.125T to 0.5T
2. There is no blind zone within the working radius (generally, the folding arm crane has a larger working blind zone near the column)
3. Hoist shell—all aluminum alloy die-casting shell (including gear box and motor back shell), CNC integrated processing, compact structure and good airtight, surface automotive grade paint.
4. Gearbox – maintenance free gearbox. The gear is a high-strength helical gear, the transmission efficiency is high and stable, the noise is smaller and the service life is higher.
5. Friction clutch – can effectively protect against overload, so as to avoid safety failure caused by overload.
6. Brake – power-off brake, power off brake. The double friction surface provides high friction. The brakes are smooth and wear less and safer.
7. Hoist motor – using variable frequency motor. The constant torque output ensures a sufficient lifting torque. High conversion efficiency and high load rate. Customized speed can be customized for customers. With overheat protection.
8. Chain—High-strength German imported RUD chain. Longer service life and smoother operation.
9. Guide chain part—customized formula high-strength wear-resistant engineering plastics as chain guide. Reduce chain wear and noise. High-strength nylon chain links are used to prevent inadvertent knotting of the chain into the chain guide.
10. Electrical parts – the mains 220V power supply plug and play. Frequency Control. Five-fold protection; undervoltage, overheating, overload, overvoltage, overcurrent. Energy saving and environmental protection, stable start and stop, customization of acceleration and deceleration.
11. Handle control – all-aluminum hand-held handle for more comprehensive protection. The ergonomic design handle makes the grip comfortable and sensitive without delay. Non-contact button, no mechanical life loss, longer life. The grip bump design ensures friction with oil in hand.
12. Hook – made of alloy forging. 360° free rotation, the hook is equipped with a safety fuse to ensure safety.
13. Folding arm lifting height and working radius can be customized one-to-one according to customer's site and usage requirements.
14. The picture shows a mobile folding arm crane. When the working radius exceeds 3m or the working environment allows, the fixed folding arm crane is preferred, which is safe and stable.

折叠式移动龙门架 FOLDING MOBILE GANTRY



产品特点

- 1、折叠设计, 方便收纳, 减少不用时的空间占用;
- 2、方便搬运, 折叠后可单人拖动;
- 3、全铝合金框架, 保证足够强度和较小的自重;
- 4、专为室外使用设计, 所有部件均防锈防腐;
- 5、适用范围广, 装配车间、维修车间、户外应急维修等;
- 6、提高工作效率, 减少工人投入, 降低工作人员疲劳, 增加工作效率;
- 7、降低生产成本, 一台多用。

Folding mobile gantry Features

1. Folding design, convenient storage, reduce space occupation when not in use.
2. Easy to carry, can be moved by one person after folding.
3. All-aluminum frame to ensure sufficient strength and small weight.
4. Designed for outdoor use, all are rust-proof and wear-resistant.
5. Wide application range, assembly workshop, maintenance workshop, outdoor emergency maintenance, etc.
6. Improve work efficiency, reduce worker input, reduce staff fatigue, and increase work efficiency.
7. It will reduce production cost by multiple uses



KACC[®]

智能电动环链平衡吊
Intelligent electric chain hoist balancer

部位	配置及特点
葫芦壳体	铝合金压铸，CNC一体加工
电机	伺服电机
减速箱	磨齿加工硬齿面斜齿轮，减速箱油浴
链轮	合金钢链轮
链条	德国进口高强度镀锌链条
控制板	伺服控制，五重保护：欠压、过热、过载、过压、过流
限位开关	CHERRY德国樱桃防水行程开关
控制手柄	多功能悬浮控制手柄，带三段精度点动功能
接插件	威浦航空插头
Shell	All aluminum alloy die casting CNC machining
Motor	Servo Motor
Gear box	Grinding machined hard toothed helical gear, gearbox oil bath
Chain wheel	Alloy steel sprocket
Chain	High-strength German imported RUD chain
Control panel	Servo control ,five protections ,under voltage,overheat , overload ,over voltage,over current
Limit switch	CHERRY German waterproof switch
Control handle	Multifunctional suspension control handle with three-stage precision jog function
Connector	Weipu aviation plug

Fine-tuning mode
Float mode



特色精调功能：最小位移仅0.3mm

Featured fine adjustment function: the minimum displacement is only 0.3mm

- (1) 控制方式为手柄操作+悬浮操作。手握手柄时进行两种操作自动切换，起升速度为无极调速；
- (2) 精调模式：通过左下角按键进入。可以通过L/M/H档位进行0.3mm/0.9mm/10mm距离的调节。
- (3) 控制板按键接口及控制板与伺服驱动器连接线路接口采用XH2.54接插件端子，模块化设计；
- (4) 1.3寸液晶屏，可以精准显示货物重量与当前模式；
- (5) 重物悬停超过一定时间(按键可调，默认120s)，电机机械抱闸使能关闭，并自动切换手动模式，以达到节能省电的作用；
- (6) 按键功能包含：最低速与最高速调节、去皮、精调档位（三档）、点动上升、点动下降、手压和手托作用力调整；
- (7) 通过手柄操作吊起重物稳定后，无需额外操作即可自动进入悬浮模式；
- (8) 伺服驱动器参数设置只需葫芦出厂前设置，无需最终用户调节；
- (9) 重物升降运行过程中无顿挫感，运行顺畅。

- (1) The control method is handle operation + floating operation. Two operations are automatically switched when holding the handle, and the lifting speed is stepless speed regulation;
- (2) Fine adjustment mode: Enter through the button in the lower left corner. The distance of 0.3mm/0.9mm/10mm can be adjusted through L/M/H gear.
- (3) The control panel button interface and the control panel and servo drive connection line interface adopt XH2.54 connector terminals, modular design;
- (4) The 1.3-inch LCD screen can accurately display the weight of the goods and the current mode;
- (5) When the heavy object is hovering for more than a certain time (adjustable by pressing the button, 120s by default), the mechanical brake of the motor is turned off and the manual mode is automatically switched to achieve the effect of energy saving and power saving;
- (6) Button functions include: minimum and maximum speed adjustment, tare, fine adjustment of gears (three gears), jog up, jog down, hand pressure and hand rest force adjustment;
- (7) After the lift is stabilized by operating the handle, it can automatically enter the suspension mode without additional operations;
- (8) Servo drive parameter settings only need to be set before the hoist leaves the factory, no end user adjustment is required;
- (9) There is no frustration during the lifting and moving of heavy objects, and the operation is smooth.



手柄操作+悬浮操作
Handle operation + Floating operation

智能电动环链平衡吊 INTELLIGENT ELECTRIC CHAIN HOIST BALANCER

如下这样的工作请交给 **KACC 智能电动环链平衡吊**

IF any conditions as below please leave to **KACC Intelligent electric chain hoist balancer**

精准定位 精密装配 Higher precision positioning and precision assembly

通过伺服电机的恒扭矩和高响应性，支持精确定位和组装等可靠自由操作性。

The constant torque and high responsiveness of the servo motor support reliable and free operability such as precise positioning and assembly.

可以双手操作 Can be operated with both hands

由于可以双手拿着货物进行搬运，因此可以抑制货物的晃动，适合上下组装的作业。

Since the cargo can be carried with both hands, the shaking of the cargo can be suppressed, and it is suitable for up and down assembly operations.

应对易碎货物 Deal with fragile goods

通过细微超低速的动作，玻璃等易碎物品也能顺利地处理。

Through the subtle ultra-low speed movement, fragile items such as glass can also be handled smoothly.

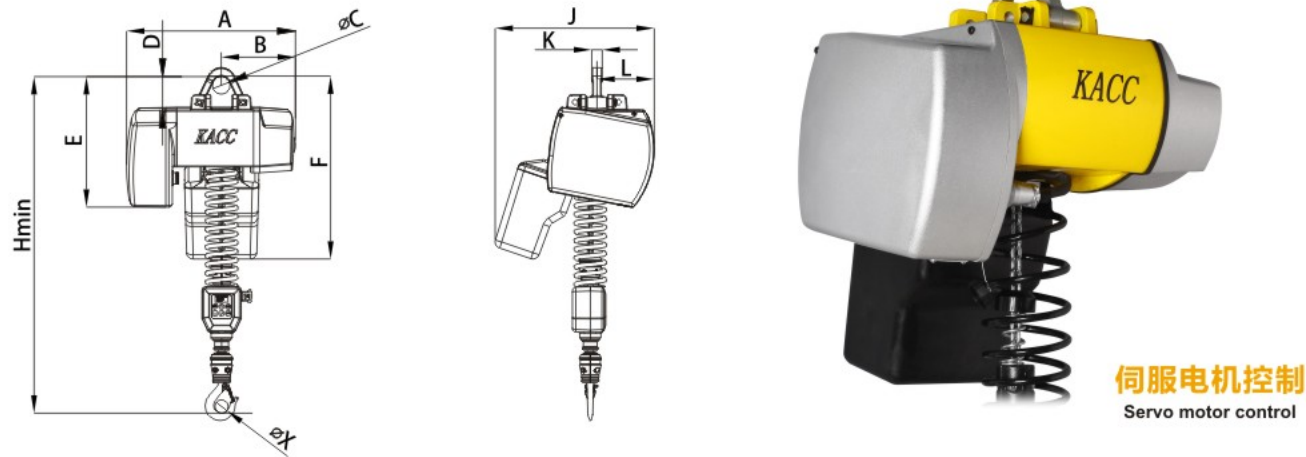

伺服电机控制
Servo motor control

型号及参数 Model and parameters

速度可根据客户需求定制 The speed can be customized according to customer requirements

型号 Model	起重量 Lifting weight (KG)	起升高度 Lifting height (M)	工作级别 Working level (ISO)	速度 Speed (M/MIN)	起重短链 Lifting short chain	链数 Number of chains	电机功率 Motor power (KW)	电机转速 Motor speed (RPM)	电机电流 Motor current (A)	电压 Voltage (V)	频率 Frequency (HZ)	负载持续率 Load continuation rate (FC%)	标配3米时净重 Net weight at 3 meters (KG)	包装尺寸 Package size (CM)
DCHXF025-80kg	80	2~6	M6	0~20	4X12	1	0.75	3000	4.8	1P 220	50	40	24	52x46x40
DCHXF025-125kg	125	2~6	M5	0~20	4X12	1	0.75	3000	4.8	1P 220	50	40	24	52x46x40
DCHXF025-250kg	250	2~6	M5	0~8	4X12	1	0.75	3000	4.8	1P 220	50	40	24	52x46x40
DCHXF025-300kg	300	2~6	M4	0~8	4X12	1	0.75	3000	4.8	1P 220	50	40	24	52x46x40
DCHXF025-500kg	500	2~6	M5	0~6	5X15	1	0.75	3000	4.8	1P 220	50	40	25	52x46x40

外形尺寸 Dimensions

单位/Unit: mm

型号 Model	起重量 Lifting weight (KG)	A	B	C	D	E	Hmin	F	J	L	K	X
DCHXF025-80kg	80	378	170	40	77	299	772	419	364	131	24	24
DCHXF025-125kg	125	378	170	40	77	299	772	419	364	131	24	24
DCHXF025-250kg	250	378	170	40	77	299	772	425	364	131	24	24
DCHXF025-300kg	300	378	170	40	77	299	772	425	364	131	24	24
DCHXF025-500kg	500	378	170	40	77	299	803	425	364	131	24	24

智能电动环链平衡吊 INTELLIGENT ELECTRIC CHAIN HOIST BALANCER



起重机
Crane

+

葫芦
Hoist

+

吊具
Spreader

特殊规格
Special specifications

KACC 智能电动环链平衡吊的系统解决方案

KACC System solution of intelligent electric chain hoist balancer

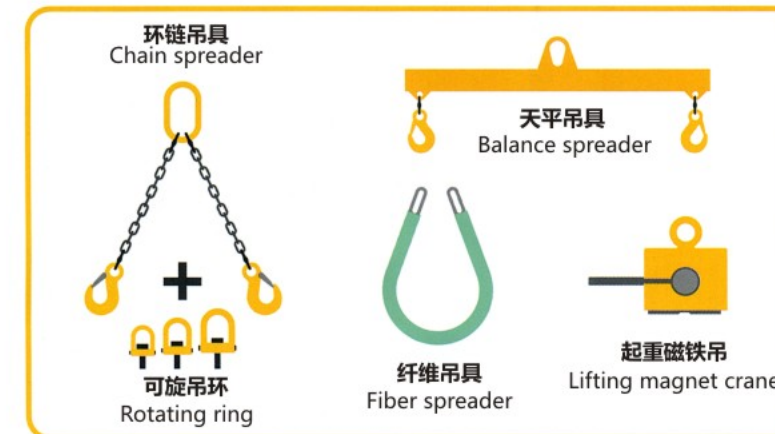
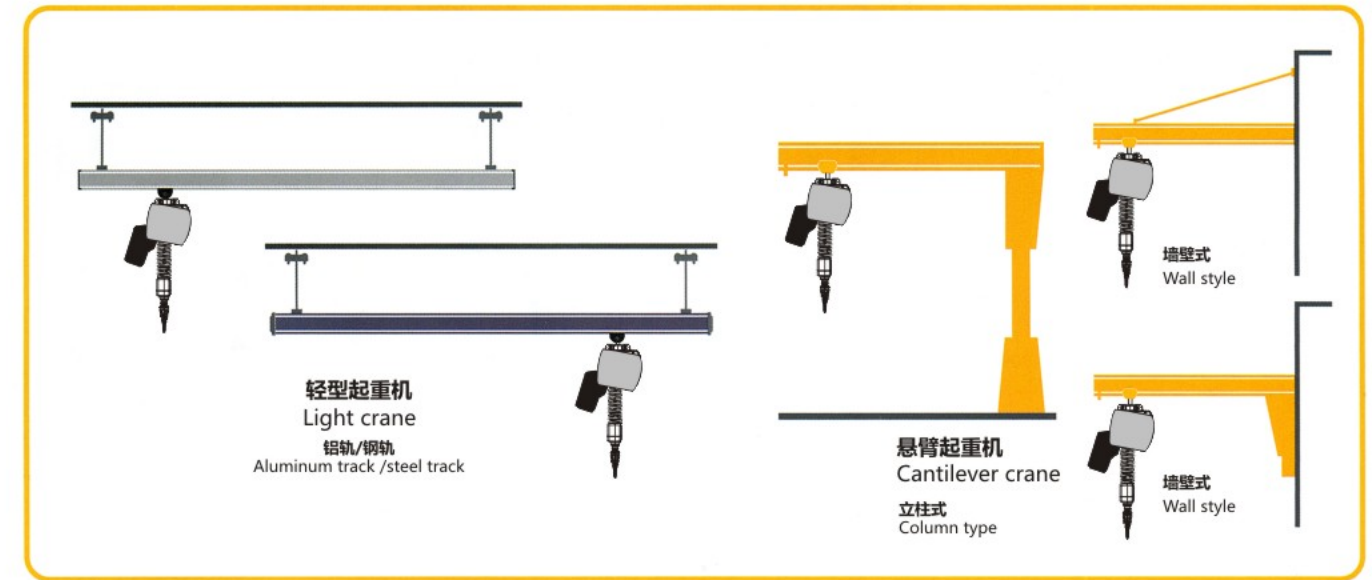

刚性升降臂 RIGID LIFTING ARM



铝轨小车
Aluminum rail trolley

刚性支撑架
Rigid support frame

电动葫芦
Electric hoist

伸缩方管 (选配铝合金型材)
Telescopic square tube
(optional aluminum alloy profile)

吊具控制按钮
Spreader control button

上下控制按键
Up and down control keys

吊具 (可根据客户需求定制个性吊具)
Spreader (personalized spreader can be
customized according to customer needs)

产品优点:

- 1、变频葫芦双速或无极调速控制;
- 2、刚性水平支撑可适配不同吊具;
- 3、伸缩臂可配备尼龙拖链控制各类吊具;
- 4、吊装稳定适用于各种精密装配及吊装场所。

Product advantages:

1. Double speed or stepless speed regulation control of frequency conversion hoist;
2. Rigid horizontal support can adapt to different slings;
3. The telescopic boom can be equipped with nylon drag chain to control all kinds of slings;
4. Stable hoisting, suitable for all kinds of precision assembly and hoisting places.

起重机方案 CRANE SCHEME

Station self-erecting crane

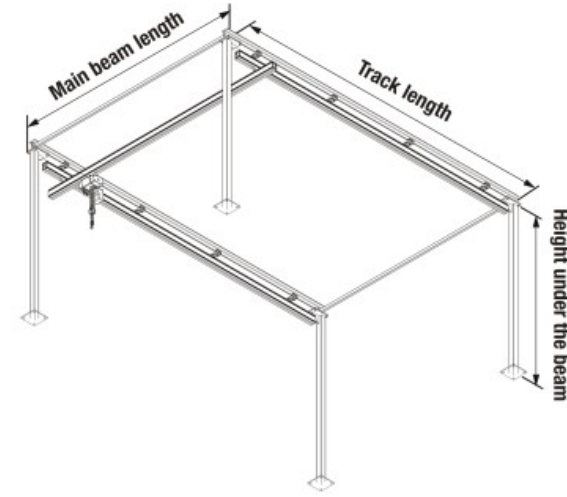

Capacity(kg): _____
Main beam length(m): _____
Track length(m): _____
Height under the beam(m): _____
Number of girders (roots): _____
Electric drive: Yes No

Station suspension crane

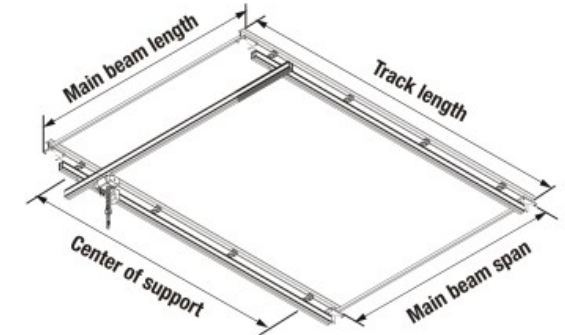

Capacity(kg): _____
Main beam length(m): _____
Track length(m): _____
Number of girders (roots): _____
Electric drive: Yes No

Column type folding arm crane

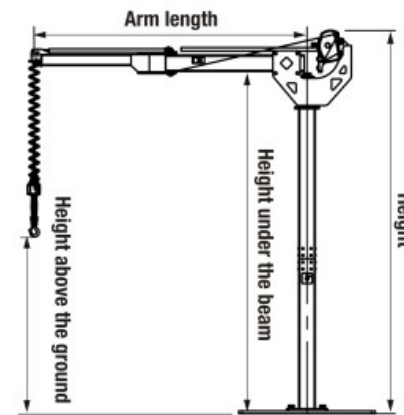

Capacity(kg): _____
Arm length(m): _____
Height above the ground(m): _____
Height under the beam(m): _____
Rotation angle: 270° 360°

Fixed column cantilever crane

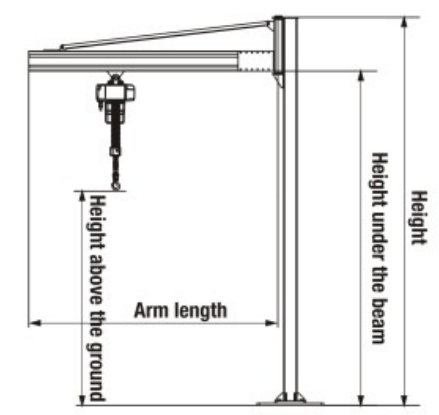

Capacity(kg): _____
Arm length(m): _____
height above the ground(m): _____
Rotation angle: 270° 360°

